

BLADE TIMING BELT REPLACEMENT T-180

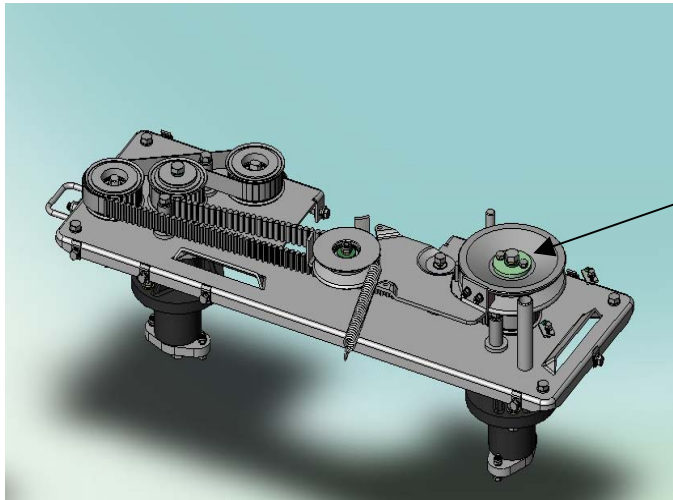

Remove the upper blade belt cover on the Blade chassis to expose the primary drive V belt.

Remove the belt then the main central bolt (reverse thread) and the 2 lock bolts retaining the primary drive V belt pulley. This pulley is on a "spline" and may be a little difficult to remove. You can use a bearing puller or with careful manipulation you can use the 2 lock bolts as a simple pulley retraction tool. I.e. remove the bolts and washer and sit a nut on the end of the shaft. This has to be just under the size of the hole in the pulley. Sit the lock plate on top of the nut, reinsert the 2 lock bolts and in stages tighten them evenly to slowly withdraw the pulley from the shaft. Note that the blade brake is engaged when the blade engagement lever is off. The brake needs to be retracted from the pulley during pulley removal.

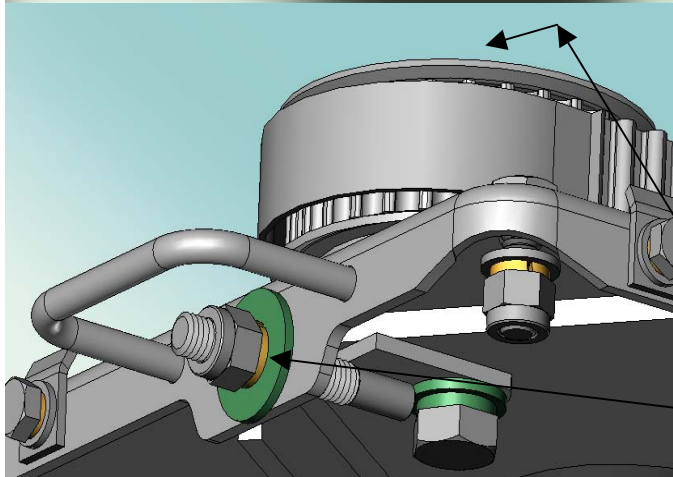

You will now be able to remove the lower timing belt cover set.

Loosen the belt tensioner-pulley lock nut (on top) and then slacken the adjuster to release belt tension and remove the old timing belt.

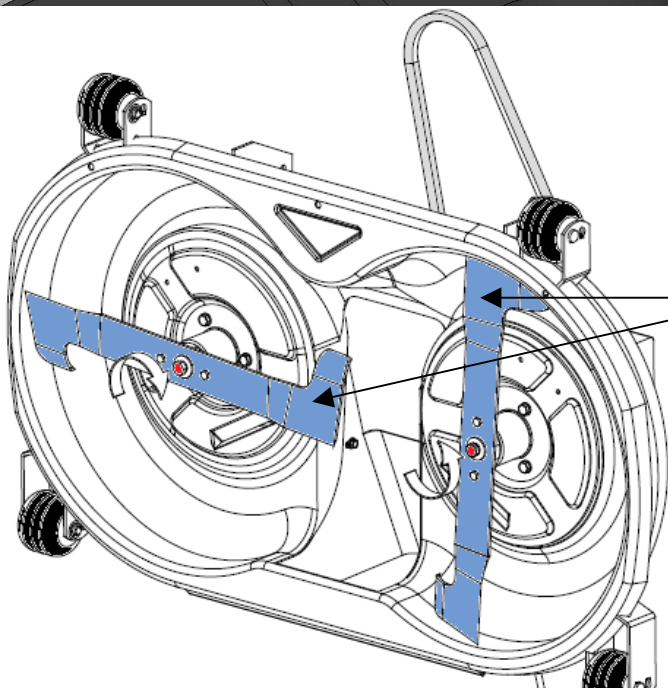

Fit the belt around the pulleys (as shown in next image) while ensuring the blades are set at 90 Degrees to one another. This is also a good opportunity to check the condition and re sharpen the blades if necessary (pg 34 in Owner's manual) Note one blade bolt is RIGHT hand thread and other has LEFT hand thread

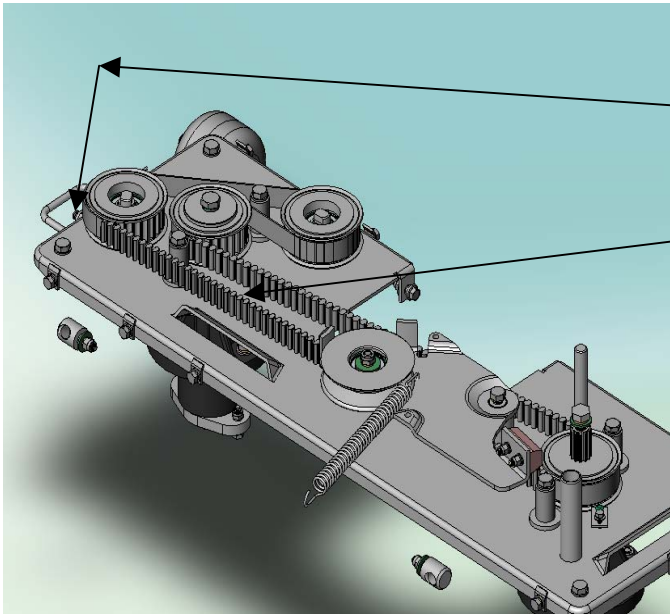

Install the new belt around the pulleys as shown here.

Once installed adjust the belt tensioner whilst checking the belt tension in the middle of the two pulleys. Adjust the tension until the middle point of the belt has only 7-8mm lateral movement.

Note: If you are not replacing the belt and are just tensioning the belt, you only need to remove the small end cover and not the pulleys as on page 1. It is a good idea to mark the belt with a piece of chalk or crayon, and rotate the belt thru a full circuit while checking both sides of the belt for any cracking, wear, damage or tooth loss. If the belt shows any signs of these problems the belt should be replaced as on page 1. Rotate by turning a blade with a gloved hand to avoid injury. Ensure that the blade drive is disengaged and that the ignition key has been removed.

Reverse the process to complete belt replacement. Ensure all bolts screws and any other fixings are tensioned sufficiently to prevent their coming undone while the mower is in use.

HAPPY MOWING